

- 1. Cornsilk (Sul-R:502)
- 2. (Sul-R:1282)
- 3. Dk. Nickel Gray (Sul-R:1329)
- 4. Sapphire (Sul-R:1534)

**Sewing\_room\_blocks\_01-4x4.dst**  
3.55x3.84 inches; 7,830 stitches  
4 thread changes; 4 colors



- 1. Maize Yellow (Sul-R:1167)
- 2. Hyacinth (Sul-R:1296)
- 3. Sapphire (Sul-R:1534)
- 4. (Sul-R:1315)

**Sewing\_room\_blocks\_02-4x4.dst**  
3.66x3.85 inches; 8,244 stitches  
4 thread changes; 4 colors

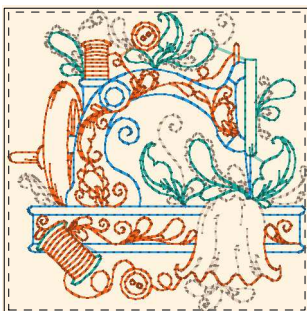

- 1. Deep Ecu (Sul-R:1149)
- 2. Dark Jade (Sul-R:1206)
- 3. Sapphire (Sul-R:1534)
- 4. (Sul-R:1315)

**Sewing\_room\_blocks\_03-4x4.dst**  
3.82x3.84 inches; 8,034 stitches  
4 thread changes; 4 colors

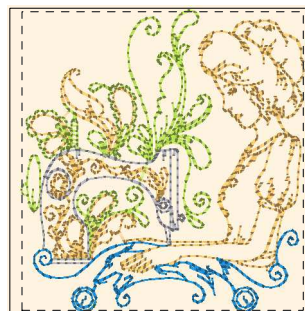

- 1. Cornsilk (Sul-R:502)
- 2. (Sul-R:1282)
- 3. Dk. Nickel Gray (Sul-R:1329)
- 4. Sapphire (Sul-R:1534)

**Sewing\_room\_blocks\_04-4x4.dst**  
3.62x3.85 inches; 7,610 stitches  
4 thread changes; 4 colors

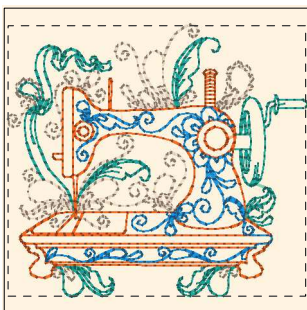

- 1. Deep Ecu (Sul-R:1149)
- 2. Dark Jade (Sul-R:1206)
- 3. (Sul-R:1315)
- 4. Sapphire (Sul-R:1534)

**Sewing\_room\_blocks\_05-4x4.dst**  
3.84x3.49 inches; 7,893 stitches  
4 thread changes; 4 colors

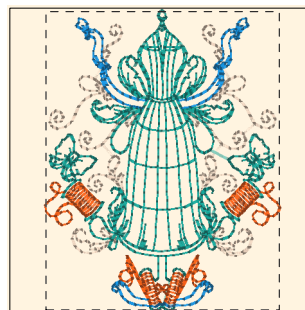

- 1. Deep Ecu (Sul-R:1149)
- 2. Dark Jade (Sul-R:1206)
- 3. (Sul-R:1315)
- 4. Sapphire (Sul-R:1534)

**Sewing\_room\_blocks\_06-4x4.dst**  
3.01x3.85 inches; 6,598 stitches  
4 thread changes; 4 colors

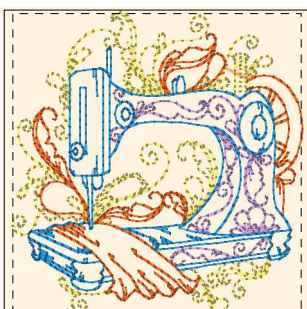

- 1. Maize Yellow (Sul-R:1167)
- 2. Hyacinth (Sul-R:1296)
- 3. (Sul-R:1315)
- 4. Sapphire (Sul-R:1534)

**Sewing\_room\_blocks\_07-4x4.dst**  
3.72x3.85 inches; 8,035 stitches  
4 thread changes; 4 colors

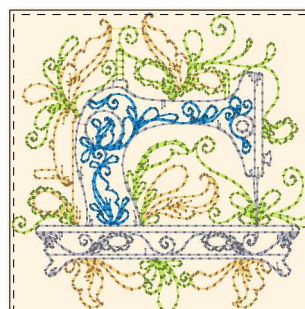

- 1. Cornsilk (Sul-R:502)
- 2. (Sul-R:1282)
- 3. Dk. Nickel Gray (Sul-R:1329)
- 4. Sapphire (Sul-R:1534)

**Sewing\_room\_blocks\_08-4x4.dst**  
3.84x3.82 inches; 8,291 stitches  
4 thread changes; 4 colors

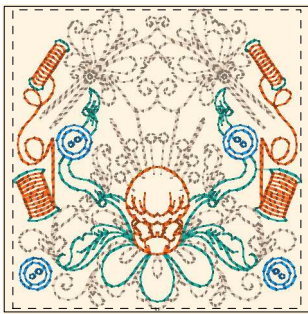

- 1. Deep Ecu (Sul-R:1149)
- 2. (Sul-R:1282)
- 3. Dark Jade (Sul-R:1206)
- 4. (Sul-R:1315)
- 5. Sapphire (Sul-R:1534)

**Sewing\_room\_blocks\_09-4x4.dst**  
3.71x3.85 inches; 8,695 stitches  
5 thread changes; 5 colors

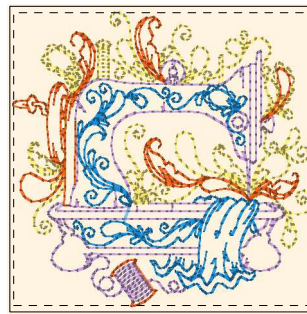

- 1. Maize Yellow (Sul-R:1167)
- 2. (Sul-R:1282)
- 3. Hyacinth (Sul-R:1296)
- 4. (Sul-R:1315)
- 5. Sapphire (Sul-R:1534)

**Sewing\_room\_blocks\_10-4x4.dst**  
3.84x3.77 inches; 8,540 stitches  
5 thread changes; 5 colors

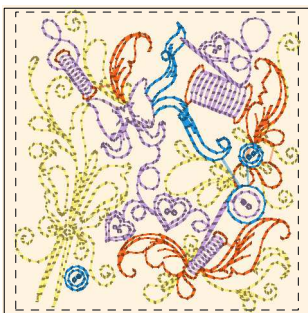

- 1. Maize Yellow (Sul-R:1167)
- 2. Hyacinth (Sul-R:1296)
- 3. (Sul-R:1315)
- 4. Sapphire (Sul-R:1534)

**Sewing\_room\_blocks\_11-4x4.dst**  
3.64x3.84 inches; 7,277 stitches  
4 thread changes; 4 colors

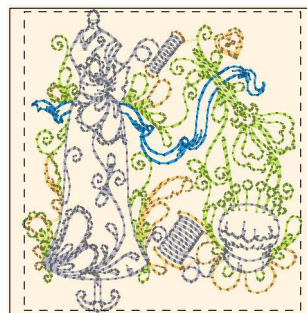

- 1. Cornsilk (Sul-R:502)
- 2. (Sul-R:1260)
- 3. (Sul-R:1282)
- 4. Dk. Nickel Gray (Sul-R:1329)
- 5. Sapphire (Sul-R:1534)

**Sewing\_room\_blocks\_12-4x4.dst**  
3.56x3.85 inches; 8,488 stitches  
5 thread changes; 5 colors