

Printed 5/13/2016



- 1. Devil Red (Isa:1306)
- 2. Poinsettia (Isa:1902)
- 3. Candy Apple (Isa:1704)
- 4. Black Chrome (Isa:2776)
- 5. White (Wil:1575)
- 6. Dark Charcoal (Isa:1375)
- 7. Charcoal (Isa:4174)

**Kitty Fashion Week -001-5x7.dst**  
4.90x4.79 inches; 19,703 stitches  
7 thread changes; 7 colors



- 1. Black Chrome (Isa:2776)
- 2. Devil Red (Isa:1306)
- 3. Tarnished Gold (Isa:442)
- 4. Poinsettia (Isa:1902)
- 5. White (Wil:1575)
- 6. Charcoal (Isa:4174)
- 7. Dark Charcoal (Isa:1375)
- 8. Candy Apple (Isa:1704)

**Kitty Fashion Week -002-5x7.dst**  
4.80x4.82 inches; 21,652 stitches  
8 thread changes; 8 colors

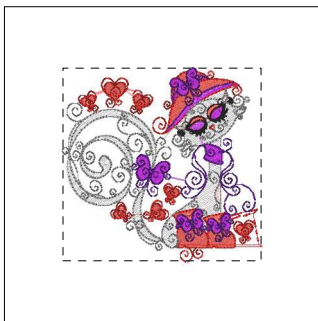

- 1. White (Wil:1575)
- 2. RGB(195,35,233)
- 3. Devil Red (Isa:1306)
- 4. RGB(26,22,26)
- 5. Pink Tulip (Isa:2155)
- 6. RGB(239,24,24)
- 7. Cobblestone (Isa:108)
- 8. Deep Purple (Isa:2900)

**Kitty Fashion Week -003-5x7.dst**  
4.95x4.81 inches; 25,439 stitches  
8 thread changes; 8 colors



- 1. Black Chrome (Isa:2776)
- 2. Devil Red (Isa:1306)
- 3. Erin Green (Isa:5912)
- 4. Sun (Isa:501)
- 5. RGB(239,24,24)
- 6. RGB(86,86,86)
- 7. RGB(26,22,26)
- 8. White (Wil:1575)

**Kitty Fashion Week -004-5x7.dst**  
4.23x6.83 inches; 23,503 stitches  
8 thread changes; 8 colors



- 1. White (Wil:1575)
- 2. Sunset Orange (Isa:1200)
- 3. Dark Orange (Isa:1321)
- 4. RGB(26,22,26)
- 5. Devil Red (Isa:1306)
- 6. RGB(239,24,24)

**Kitty Fashion Week -005-5x7.dst**  
5.81x7.00 inches; 33,133 stitches  
6 thread changes; 6 colors



- 1. White (Wil:1575)
- 2. Pink Tulip (Isa:2155)
- 3. Venetian Blue (Isa:3541)
- 4. Deep Purple (Isa:2900)
- 5. Devil Red (Isa:1306)
- 6. RGB(239,24,24)
- 7. White (Wil:1575)
- 8. Sun (Isa:501)
- 9. Cobblestone (Isa:108)
- 10. RGB(26,22,26)

**Kitty Fashion Week -006-5x7.dst**  
4.80x5.01 inches; 23,677 stitches  
10 thread changes; 9 colors



- 1. RGB(63,63,63)
- 2. RGB(26,22,26)
- 3. RGB(86,86,86)
- 4. White (Wil:1575)
- 5. RGB(255,82,82)
- 6. RGB(239,24,24)

**Kitty Fashion Week -007-5x7.dst**  
4.80x4.89 inches; 18,876 stitches  
6 thread changes; 6 colors

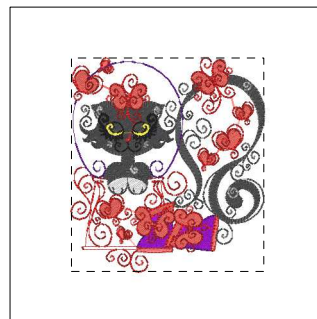

- 1. White (Wil:1575)
- 2. Devil Red (Isa:1306)
- 3. Black Chrome (Isa:2776)
- 4. Venetian Blue (Isa:3541)
- 5. RGB(26,22,26)
- 6. White (Wil:1575)
- 7. Devil Red (Isa:1306)
- 8. Black Chrome (Isa:2776)
- 9. Venetian Blue (Isa:3541)
- 10. Sun (Isa:501)
- 11. RGB(239,24,24)
- 12. RGB(86,86,86)
- 13. RGB(26,22,26)
- 14. White (Wil:1575)
- 15. Deep Purple (Isa:2900)

**Kitty Fashion Week -008-5x7.dst**  
4.81x5.33 inches; 25,825 stitches  
15 thread changes; 9 colors

Printed 5/13/2016



- 1. White (Wil:1500)
- 2. Devil Red (Isa:1306)
- 3. RGB(239,24,24)
- 4. Sunset Orange (Isa:1200)
- 5. White (Wil:1500)
- 6. Tropical Blue (Isa:3901)
- 7. RGB(26,22,26)
- 8. Dark Orange (Isa:1321)

**Kitty Fashion Week -009-5x7.dst**  
4.85x4.80 inches; 22,816 stitches  
8 thread changes; 7 colors



- 1. White (Wil:1500)
- 2. Pink Tulip (Isa:2155)
- 3. Venetian Blue (Isa:3541)
- 4. Devil Red (Isa:1306)
- 5. Sun (Isa:501)
- 6. RGB(239,24,24)
- 7. Cobblestone (Isa:108)
- 8. RGB(26,22,26)
- 9. Deep Purple (Isa:2900)

**Kitty Fashion Week -010-5x7.dst**  
4.81x5.94 inches; 26,854 stitches  
9 thread changes; 9 colors



- 1. White (Wil:1500)
- 2. Skylight (Isa:145)
- 3. Leadville (Isa:112)
- 4. Devil Red (Isa:1306)
- 5. Poinsettia (Isa:1902)
- 6. RGB(239,24,24)
- 7. Cobblestone (Isa:108)
- 8. RGB(26,22,26)

**Kitty Fashion Week -011-5x7.dst**  
4.82x6.81 inches; 25,884 stitches  
8 thread changes; 8 colors

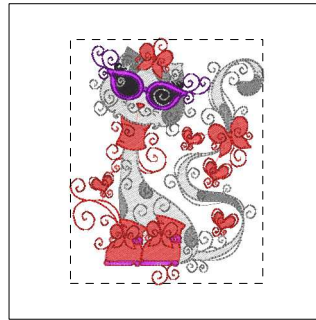

- 1. RGB(26,22,26)
- 2. White (Wil:1500)
- 3. RGB(130,130,130)
- 4. RGB(255,82,82)
- 5. RGB(195,35,233)
- 6. RGB(239,24,24)
- 7. RGB(26,22,26)
- 8. RGB(160,160,160)
- 9. RGB(109,0,149)

**Kitty Fashion Week -012-5x7.dst**  
4.81x6.09 inches; 27,039 stitches  
9 thread changes; 8 colors